

RoHS Compliant

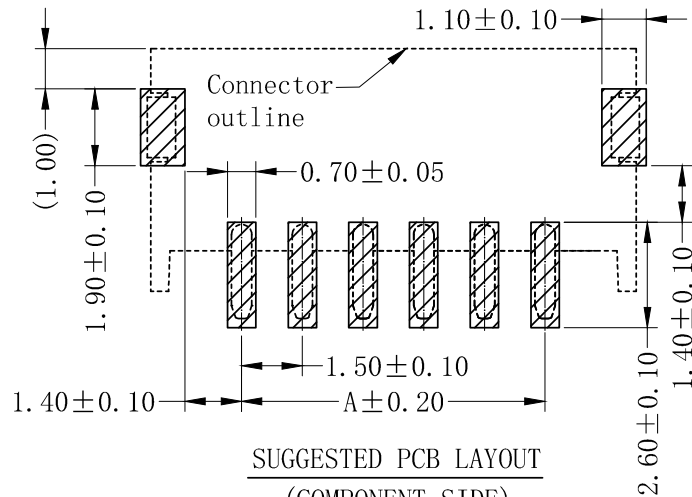

SUGGESTED PCB LAYOUT
(COMPONENT SIDE)

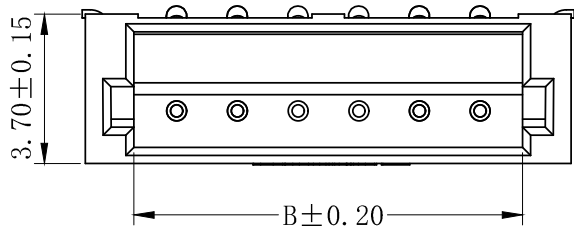
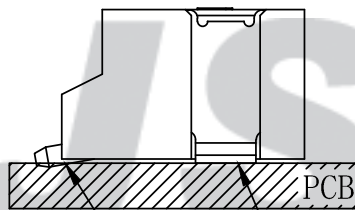
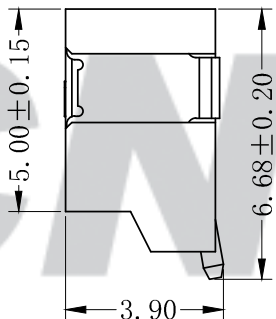
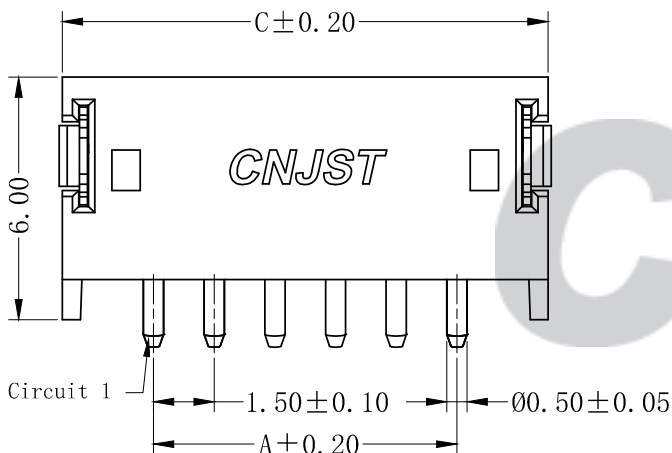

产品平贴后PIN针、固定PIN
与焊接面间隙不大于0.1mm

SPECIFICATION

- 1 Contact resistance: $\leq 20m\Omega$
- 2 Insulation resistance: $\geq 500M\Omega$
- 3 Rated voltage: 125 V AC DC
- 4 Rated current: 1.0 A AC DC
- 5 Withstand Voltage: 500V AC/minute
- 6 Temperature Range: $-25^{\circ}C \sim +85^{\circ}C$

ORDER INFORMATION:

A1501AWR-**-F2MA-R

PART No. _____
 No. OF CIRCUITS: _____
 02~16
 PLASTIC MATERIAL: _____
 F2M=LCP

PACKAGING:
 R=REEL
 PLATING:
 A=Tin-plated

Circuits	Dimensions (mm)		
	A	B	C
02	1.50	3.60	6.00
03	3.00	5.10	7.50
04	4.50	6.60	9.00
05	6.00	8.10	10.50
06	7.50	9.60	12.00
07	9.00	11.10	13.50
08	10.50	12.60	15.00
09	12.00	14.10	16.50
10	13.50	15.60	18.00
11	15.00	17.10	19.50
12	16.50	18.60	21.00
13	18.00	20.10	22.50
14	19.50	21.60	24.00
15	21.00	23.10	25.50
16	22.50	24.60	27.00

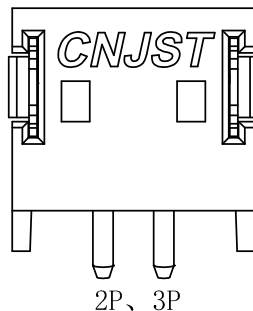
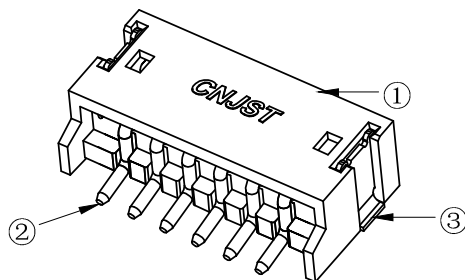

专利产品

Tolerance X.X ±0.30 X.XX ±0.20 X.XXX ±0.10 Angle ±3.0°	CNJST 捷仕泰企业		Drawn: 黄美程 2022.06.24
	Model No.: A1501AWR-**-F2MA-R		Checked: 吴丹平
	Model Name: 1.50mm PITCH 90° WAFER-SMT TYPE		Approved: 林旭芝
	UNIT: mm	SCALE: FULL	REVISION: C/0
			DWG NO. CNJST/GCCP-0043

REV.	DATE	DESCRIPTION	APPD.	NO.	DESCRIPTION	QTY	MATERIAL	PLATING/COLOR
C/0	2022.06.24	统一标准 更新模版	黄美程	③	Solder Tab	2	Phosphor Bronze	Tin-plated
B/0	2020.01.07	NEW RELEASE	黄金林	②	Contacts	2~16	Brass	Tin-plated
				①	Insulator	1	LCP (UL94V-0)	Nature