

RoHS Compliant

成品图

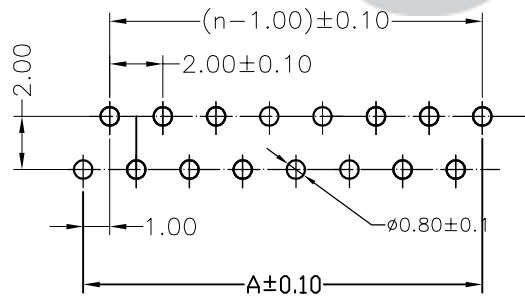

SUGGESTED PCB LAYOUT
(COMPONENT SIDE)

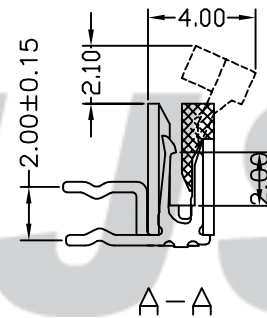
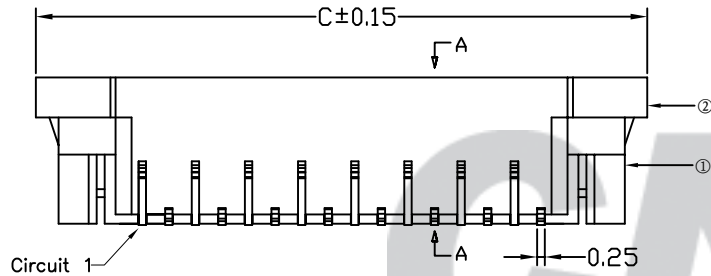
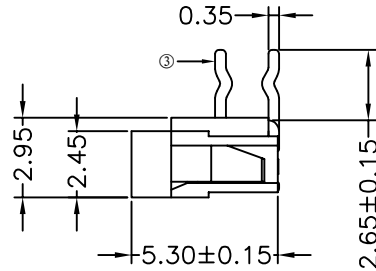
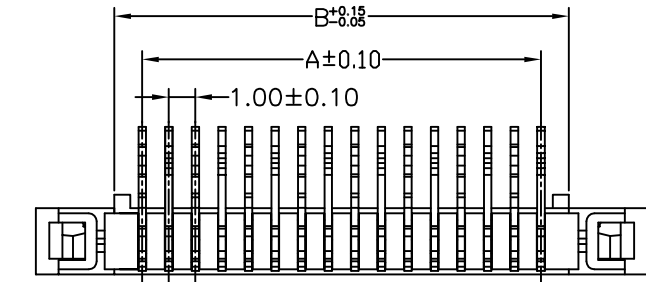
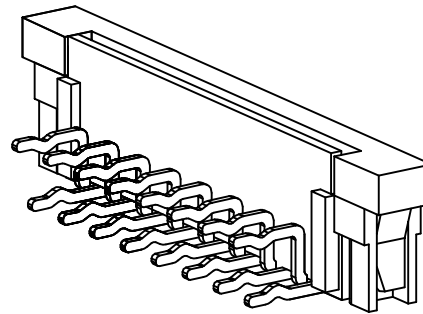

SPECIFICATION

- 1 Contact resistance: $\leq 50m\Omega$
- 2 Insulation resistance: $\geq 500M\Omega$
- 3 Rated voltage: 50 V AC DC
- 4 Rated current: 0.5 A AC DC
- 5 Withstand Voltage: 500V AC/minute
- 6 Temperature Range: $-25^{\circ}C \sim +105^{\circ}C$

ORDER INFORMATION:

F1004AWX-**-F2MA-G

Part No.
No. of Circuits:
04~40
PLASTIC MATERIAL:
F2M=LCP (Locker:LCP)

PACKAGING:
G=TUBE
PLATING:
A=Tin-Plated

| Circuits | Dimensions(mm) | | | Circuits | Dimensions(mm) | | |
|----------|----------------|-------|-------|----------|----------------|-------|-------|
| | A | B | C | | A | B | C |
| 04 | 3.00 | 5.10 | 11.00 | 23 | 22.00 | 24.10 | 30.00 |
| 05 | 4.00 | 6.10 | 12.00 | 24 | 23.00 | 25.10 | 31.00 |
| 06 | 5.00 | 7.10 | 13.00 | 25 | 24.00 | 26.10 | 32.00 |
| 07 | 6.00 | 8.10 | 14.00 | 26 | 25.00 | 27.10 | 33.00 |
| 08 | 7.00 | 9.10 | 15.00 | 27 | 26.00 | 28.10 | 34.00 |
| 09 | 8.00 | 10.10 | 16.00 | 28 | 27.00 | 29.10 | 35.00 |
| 10 | 9.00 | 11.10 | 17.00 | 29 | 28.00 | 30.10 | 36.00 |
| 11 | 10.00 | 12.10 | 18.00 | 30 | 29.00 | 31.10 | 37.00 |
| 12 | 11.00 | 13.10 | 19.00 | 31 | 30.00 | 32.10 | 38.00 |
| 13 | 12.00 | 14.10 | 20.00 | 32 | 31.00 | 33.10 | 39.00 |
| 14 | 13.00 | 15.10 | 21.00 | 33 | 32.00 | 34.10 | 40.00 |
| 15 | 14.00 | 16.10 | 22.00 | 34 | 33.00 | 35.10 | 41.00 |
| 16 | 15.00 | 17.10 | 23.00 | 35 | 34.00 | 36.10 | 42.00 |
| 17 | 16.00 | 18.10 | 24.00 | 36 | 35.00 | 37.10 | 43.00 |
| 18 | 17.00 | 19.10 | 25.00 | 37 | 36.00 | 38.10 | 44.00 |
| 19 | 18.00 | 20.10 | 26.00 | 38 | 37.00 | 39.10 | 45.00 |
| 20 | 19.00 | 21.10 | 27.00 | 39 | 38.00 | 40.10 | 46.00 |
| 21 | 20.00 | 22.10 | 28.00 | 40 | 39.00 | 41.10 | 47.00 |
| 22 | 21.00 | 23.10 | 29.00 | | | | |

Tolerance
X.X ±0.30
X.XX ±0.20
X.XXX ±0.10
Angle ±3.0°

Model Name: 1.00mm SMT ZIF Downside FFC/FPC Connectors
Model No: F1004AWX-**-F2MA-G

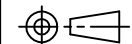

SCALE: FULL

REVISION: B/0

Drawn: 张育斌 2016.06.11

Checked: 林旭芝

Approved: 刘祚杰

DWG NO. CNJST/GCCP-0248

| NO. | DESCRIPTION | QTY | MATERIAL | PLATING/COLOR |
|-----|-------------|-------|-----------------|---------------|
| ③ | Locker | 1 | LCP (UL94V-0) | Black |
| ② | Contacts | 04~40 | Phosphor Bronze | Tin-plated |
| ① | Insulator | 1 | LCP (UL94V-0) | Nature |

| REV. | DATE | DESCRIPTION | APPD. |
|------|------------|-------------|-------|
| B/0 | 2016.04.12 | NEW RELEASE | |

UNIT: mm
CNJST 浙江捷仕泰电子有限公司
ZHEJIANG JIESHITAI ELECTRONIC CO., LTD